

# Panasonic®

## Installation Manual

---

### Additional Digital Cordless Handset

Model No. **KX-PRSA10E**  
**KX-PRWA10E**

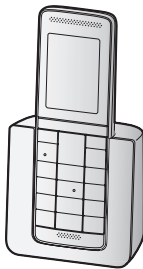

KX-PRSA10



KX-PRWA10

### Thank you for purchasing a Panasonic product.

This unit is an additional handset compatible with the following series of Panasonic Digital Cordless Phone:

- KX-PRS120 (KX-PRSA10)
- KX-PRW120 (KX-PRWA10)

(The corresponding models are subject to change without notice.)

You must register this handset with your base unit before it can be used. This installation manual describes only the steps needed to register and begin using the handset. Please read the base unit's operating instructions for further details.

Please read this installation manual before using the unit and save it for future reference.

For enquiry, please call hotline: (+852) 23130666

## ***Installation***

---

---

### **Accessory information**

---

#### **Supplied accessories**

<b>Accessory item/Part number</b>	<b>Quantity</b>
Charger*1	1
AC adaptor/PNLV233EKZ	1
Rechargeable batteries*2	2
Handset cover*3	1

\*1 KX-PRSA10: PNLC1047ZW (White)  
KX-PRWA10: PNLC1046ZW (White)

\*2 Please read the base unit's operating instructions for replacement battery information.

\*3 The handset cover comes attached to the handset.

**Note:**

- Please read the base unit's operating instructions for additional/replacement accessories.
- Please read "General information" of the base unit's operating instructions for information regarding R&TTE Directive.

## Setting up

### Connections

- ① Connect the AC adaptor plug to the unit until you hear a click.
- ② Connect the AC adaptor to the power outlet.
- ③ KX-PRSA10: Fasten the cord by hooking it.

#### ■ KX-PRSA10

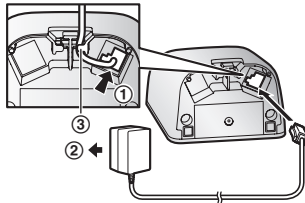

#### ■ KX-PRWA10

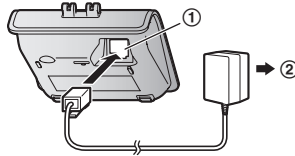

#### Note:

- Use only the supplied Panasonic AC adaptor PNLV233E.
- The AC adaptor must remain connected at all times. (It is normal for the adaptor to feel warm during use.)

### Battery installation/Battery charging

#### Important:

- Use the supplied rechargeable batteries. For replacement, we recommend using the Panasonic rechargeable batteries noted in the base unit's operating instructions.
- USE ONLY rechargeable Ni-MH batteries AAA (R03) size (①).
- Do NOT use Alkaline/Manganese/Ni-Cd batteries.
- Confirm correct polarities (⊕, ⊖).

#### Charge for about 7 hours.

- Confirm "Charging" is displayed (②).
- When the batteries are fully charged, "Fully charged" is displayed.

## Installation

---

### ■ KX-PRSA10

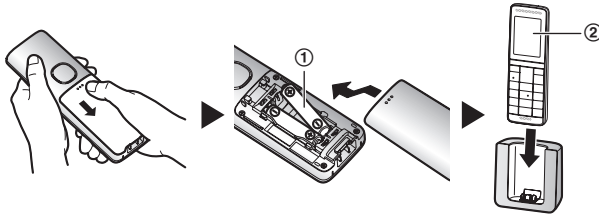

### ■ KX-PRWA10

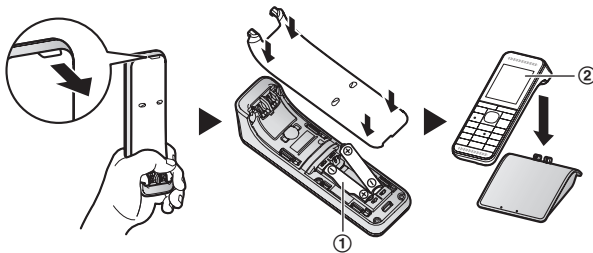

#### Note:

- The handset display may show "Please wait for 1 minute." when the handset is placed on the charger if it is not registered to the base unit.
- If the batteries are fully charged, but the operating time seems to be shorter, clean the battery ends (+, -) and the charge contacts with a dry cloth and charge again.

---

## Registering the handset to the base unit

Ensure that the handset is switched on. If it is not on, press and hold [**⏻**] for few seconds to turn the handset on.

### 1 Handset:

Lift the handset and press [**⏻**].

### 2 Base unit:

Press and hold [**📞**] for about 5 seconds.

- If all registered handsets start ringing, press [**📞**] again to stop, then repeat this step.

■ KX-PRSA10



■ KX-PRWA10

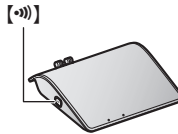

### 3 Handset:

Place the handset on the base unit or charger.

- Continue the operation even when the handset display shows “Please wait for 1 minute.”

### 4 With the handset still on the base unit or charger, wait until a confirmation tone sounds and is displayed.

#### Note:

- If an error tone sounds, or if  is displayed, register the handset according to the base unit's operating instructions.

## For your safety

To prevent severe injury and loss of life/property, read this section carefully before using the product to ensure proper and safe operation of your product.

### WARNING

#### Power connection

- Completely insert the AC adaptor/power plug into the power outlet. Failure to do so may cause electric shock and/or excessive heat resulting in a fire.
- Regularly remove any dust, etc. from the AC adaptor/power plug by pulling it from the power outlet, then wiping with a dry cloth. Accumulated dust may cause an insulation defect from moisture, etc. resulting in a fire.
- Unplug the product from power outlets if it emits smoke, an abnormal smell, or makes an unusual noise. These conditions can cause fire or electric shock. Confirm that smoke has stopped emitting and contact an authorised service centre.

#### Installation

- To prevent the risk of fire or electrical shock, do not expose the product to rain or any type of moisture.

---

## ***Installation***

---

- Do not place or use this product near automatically controlled devices such as automatic doors and fire alarms. Radio waves emitted from this product may cause such devices to malfunction resulting in an accident.

---

## **CAUTION**

---

### **Installation and location**

- The AC adaptor is used as the main disconnect device. Ensure that the AC outlet is installed near the product and is easily accessible.

---

### **Battery**

- We recommend using the supplied batteries or additional/replacement batteries noted in the base unit's operating instructions for replacement battery information. **USE ONLY rechargeable Ni-MH batteries AAA (R03) size.**
- Do not mix old and new batteries.
- Do not open or mutilate the batteries. Released electrolyte from the batteries is corrosive and may cause burns or injury to the eyes or skin. The electrolyte is toxic and may be harmful if swallowed.
- Exercise care when handling the batteries. Do not allow conductive materials such as rings, bracelets, or keys to touch the batteries, otherwise a short circuit may cause the batteries and/or the conductive material to overheat and cause burns.
- Charge the batteries provided with or identified for use with this product only, in accordance with the instructions and limitations specified in this manual.
- Only use a compatible base unit (or charger) to charge the batteries. Do not tamper with the base unit (or charger). Failure to follow these instructions may cause the batteries to swell or explode.

---

## **Important safety instructions**

When using your product, basic safety precautions should always be followed to reduce the risk of fire, electric shock, and injury to persons, including the following:

1. Do not use this product near water for example, near a bathtub, washbowl, kitchen sink, or laundry tub, in a wet basement or near a swimming pool.
2. Do not use the telephone to report a gas leak in the vicinity of the leak.
3. Use only the power cord and batteries indicated in this manual. Do not dispose of batteries in a fire. They may explode. Check with local codes for possible special disposal instructions.

**SAVE THESE INSTRUCTIONS**

### Other information

- Operating the product near electrical appliances may cause interference. Move away from the electrical appliances.

**CAUTION:** Risk of explosion if battery is replaced by an incorrect type. Dispose of used batteries according to the instructions.

#### Routine care

- Wipe the outer surface of the product with a soft moist cloth.
- Do not use benzine, thinner, or any abrasive powder.

#### Notice for product disposal, transfer, or return

- This product can store your private/confidential information. To protect your privacy/confidentiality, we recommend that you erase information such as phonebook or caller list entries from the memory before you dispose of, transfer, or return the product.

#### Information for Users on Collection and Disposal of Old Equipment and used Batteries

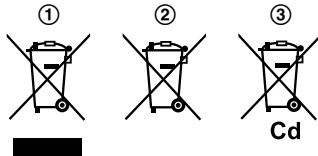

These symbols (①, ②, ③) on the products, packaging, and/or accompanying documents mean that used electrical and electronic products and batteries should not be mixed with general household waste.

For proper treatment, recovery and recycling of old products and used batteries, please take them to applicable collection points, in accordance with your national legislation and the Directives 2002/96/EC and 2006/66/EC.

By disposing of these products and batteries correctly, you will help to save valuable resources and prevent any potential negative effects on human health and the environment which could otherwise arise from inappropriate waste handling.

For more information about collection and recycling of old products and batteries, please contact your local municipality, your waste disposal service or the point of sale where you purchased the items.

Penalties may be applicable for incorrect disposal of this waste, in accordance with national legislation.

## ***Installation***

---

### **For business users in the European Union**

If you wish to discard electrical and electronic equipment, please contact your dealer or supplier for further information.

---

### **Information on Disposal in other Countries outside the European Union**

These symbols (①, ②, ③) are only valid in the European Union. If you wish to discard these items, please contact your local authorities or dealer and ask for the correct method of disposal.

---

### **Note for the battery symbol**

This symbol (②) might be used in combination with a chemical symbol (③). In this case it complies with the requirement set by the Directive for the chemical involved.

---